

## For rotating screw R



## Trapezoidal screw Z-.-R-Tr



Material: C35 or Ck45 (stainless steel on request)  
 Quality: DIN 103, 7e rolled, from Tr 80 whirled  
 Pitch accuracy 0.2 mm / 300 mm  
 Right-handed (double-pitch, left-handed on request)

Part no.	Tr	Ø	LA	kg/m
GSZ-2-R-Tr	Tr 16x4	10j6	12	1.2
Z-5-R-Tr	Tr 18x4	12j6	15	1.6
Z-10-R-Tr	Tr 20x4	15j6	20	2.0
Z-25-R-Tr	Tr 30x6	20j6	25	4.5
Z-35-R-Tr	Tr 40x7	25j6	30	8.0
Z-50-R-Tr	Tr 40x7	25j6	30	8.0
Z-100-R-Tr	Tr 55x9	40j6	45	16
Z-150-R-Tr	Tr 60x9	45j6	55	19
Z-250-R-Tr	Tr 80x16	60j6	75	32
Z-350-R-Tr	Tr 100x16	80j6	100	52
Z-500-R-Tr	Tr 120x16	95j6	120	77
Z-750-R-Tr	Tr 140x20	100j6	120	105
Z-1000-R-Tr	Tr 160x20	130j6	175	139



## Opposed bearing plate GLP

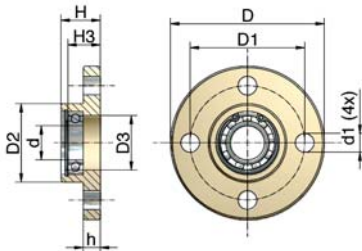

Material: Steel, corrosion-resistant  
 Hard anodised aluminium (GSZ-2-GLP)  
 Up to Z-150 stainless steel bearings  
 The ball bearing is already fitted at delivery  
 Identical to the previous MSZ type

Part no.	ØD	ØD1	ØD2	ØD3	Ød	Ød1
GSZ-2-GLP	50	40	26	19	10	5.5
Z-5-GLP	65	48	29	20	12	9
Z-10-GLP	80	60	39	28	15	11
Z-25-GLP	90	67	46	32	20	11
Z-35/50-GLP	110	85	60	42	25	13
Z-100-GLP	150	117	85	60	40	17
Z-150-GLP	170	130	90	68	45	21
Z-250-GLP	210	165	120	85	60	26
Z-350-GLP	265	205	145	95	80	26
Z-500-GLP	310	240	170	130	95	38
Z-750-GLP	350	280	200	168	100	6x32

Part no.	h	H	H3	Lager	Si ring	kg
GSZ-2-GLP	6	16	12	61900.2RS	J 22	0.05
Z-5-GLP	7	20	13	61901.2RS	J 24	0.17
Z-10-GLP	8	21	17	6002.2RS	J 32	0.30
Z-25-GLP	10	23	19	61904.2RS	J 37	0.48
Z-35/50-GLP	15	30	22	6005.2RS	J 47	1.05
Z-100-GLP	20	50	35	6008.2RS	J 68	3.10
Z-150-GLP	25	50	31	6009.2RS	J 75	3.70
Z-250-GLP	30	60	50	2x6012.2RS	J 95	6.90
Z-350-GLP	32	65	54	2x6016.2RS	J125	11.50
Z-500-GLP	40	100	60	2x6019.2RS	J145	24.00
Z-750-GLP	40	100	83	2x6020.2RS	J180	32.00

The opposed bearing plate increases the smoothness of operation and the resistance of the screw to buckling.  
 Allow 5 mm at the end of the screw for length compensation.

