

## Clamp coupling KUZ-KK

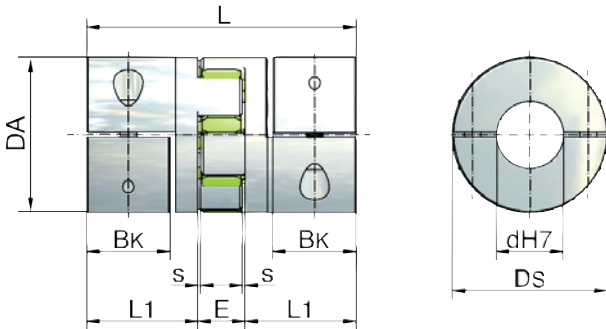

\*BK=shaft extension clamping length

### Standard bores "d" [mm]

KUZ-KK-16	8, 9, 10, 11, 12, 14, 15, 16
KUZ-KK-24	9, 10, 11, 12, 14, 15, 16, 18, 19, 20, 22
KUZ-KK-32	10, 11, 12, 14, 15, 16, 18, 19, 20, 22, 24, 25, 28, 30, 32
KUZ-KK-35	12, 15, 16, 18, 20, 22, 24, 25, 28, 30, 32, 35
KUZ-KK-45	16, 19, 20, 22, 24, 25, 28, 30, 32, 35, 38, 40, 42, 45
KUZ-KK-60	25, 28, 32, 38, 40, 42, 45, 48, 50, 55

### Coupling with split shells

- Split shells permit easy radial insertion
- High concentricity
- High clamping forces
- Low moment of inertia
- Stepless adjustment facility thanks to the clamp hub rather than a fitted drive key
- Keyway available on request
- Material: high-tensile aluminium

### Elastomer star

- Permanently free of play, dampens vibration
- Shore hardness 64D
- Colour: ZIMM green
- Temperature range: 0°C to +70°C reduced to -20°C, to +100°C (Mx0.55)

## Dimensions, technical data

Coupling size	Dimensions							Clamping screw M	Tightening torque [Nm]	Moment of inertia [10 <sup>-3</sup> kgm <sup>2</sup> ]	Torsional stiffness C <sub>tdyn</sub> [Nm/rad]	Weight [kg]
	DA [mm]	DS [mm]	L [mm]	L1 [mm]	BK* [mm]	s [mm]	E [mm]					
KUZ-KK-16	32	32	54	21	15	1.5	12	M4	4	0.01	1375	0.10
KUZ-KK-24	42	44.5	66	25	17	1.5	16	M5	8	0.08	3700	0.20
KUZ-KK-32	56	57	98	40	30	2	18	M6	15	0.24	9917	0.55
KUZ-KK-35	67	68	114	47	35	2	20	M8	35	0.51	24417	0.90
KUZ-KK-45	82	85	134	55	40	2	24	M10	70	2.4	33667	1.60
KUZ-KK-60	102	105	156	65	50	2	26	M12	120	6	67667	2.70



### Ordering example:

KUZ-KK-32-20/24

Size  
Bore d end 1  
Bore d end 2

## Torques

Coupling size	Elastomer star		Maximum transmittable torque of clamp hub depending on the bore diameter (clamp force)																	
	Rated torque [Nm]	Max. torque [Nm]	Ø9 [Nm]	Ø11 [Nm]	Ø14 [Nm]	Ø16 [Nm]	Ø19 [Nm]	Ø20 [Nm]	Ø22 [Nm]	Ø24 [Nm]	Ø25 [Nm]	Ø28 [Nm]	Ø30 [Nm]	Ø32 [Nm]	Ø38 [Nm]	Ø40 [Nm]	Ø42 [Nm]	Ø45 [Nm]	Ø48 [Nm]	Ø55 [Nm]
KUZ-KK-16	12	25	21	26	33	37	-	-	-	-	-	-	-	-	-	-	-	-	-	-
KUZ-KK-24	17	34	-	41	52	60	70	74	81	-	-	-	-	-	-	-	-	-	-	-
KUZ-KK-32	60	120	-	60	76	87	104	109	120	131	136	153	164	175	-	-	-	-	-	-
KUZ-KK-35	160	320	-	-	-	120	-	188	206	-	235	-	-	301	-	-	-	-	-	-
KUZ-KK-45	325	650	-	-	-	325	386	406	447	488	508	568	610	650	772	-	854	915	-	-
KUZ-KK-60	530	1060	-	-	-	-	-	-	-	-	570	638	-	730	866	914	960	1029	1097	1250

1. Axial offset - axial

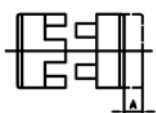

2. Axial offset - lateral

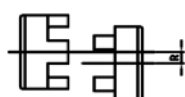

3. Angular error - angular



Size	max. axial offset in mm (axial)	max. axial offset in mm (lateral)	max. angular error in degrees (angular)
KUZ-KK-16	±1	0.08	1°
KUZ-KK-24	±2	0.08	1°
KUZ-KK-32	±2	0.10	1°
KUZ-KK-35	±2	0.15	1°
KUZ-KK-45	±2	0.12	1°
KUZ-KK-60	±2	0.14	1°