

RVP/U

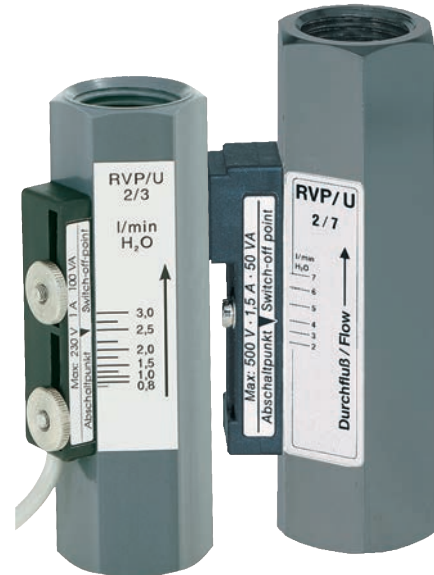
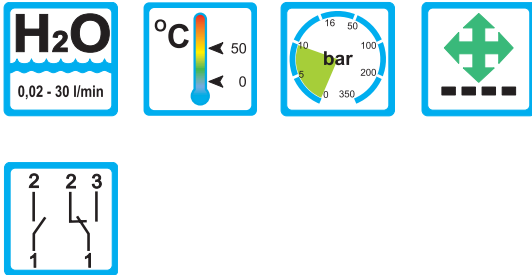

Areas of Application

Method of Operation

- Float measuring principle

Fields of operation

- Mechanical engineering e.g. welding machinery, laser plants
- Medical technology
- Research and development
- Cooling systems and cooling circuits

Features

- Universal mounting
- High reliability
- Infinitely variable switchpoint adjustment through user
- Suitable for distilled or demineralized water
- Threaded connection, special threads on request

Installation information

- The operating instructions for RVP/U must be observed!
- Download: www.meister-flow.com

Operating Data

Operating pressure, max.	10 bar
Pressure drop	0,02 - 0,3 bar
Temperature, max.	50 °C
Accuracy	±10 % of full scale

Measuring Ranges

Type	Flow ranges for H ₂ O at 20 °C ⁽¹⁾		
	[l/min]	[gph]	[gpm]
RVP/U-2/02	0,02 - 0,21	0,3 - 3,35	
RVP/U-2/06	0,2 - 0,6	3,2 - 9,5	
RVP/U-2/1	0,4 - 1,8	6,5 - 28,5	
RVP/U-2/3	0,8 - 3,2	13,0 - 51,0	
RVP/U-2/7	2 - 7	32,0 - 111,0	
RVP/U-2/13	3 - 13	48,0 - 205,0	
RVP/U-2/20	4 - 20	65,0 - 315,0	
RVP/U-2/30	8 - 30	130,0 - 480,0	

⁽¹⁾ The specified data are switch-off points other switch ranges on request.

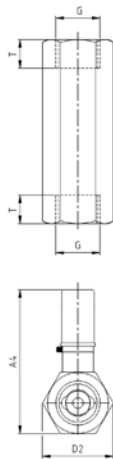

mit Schaltkontakt

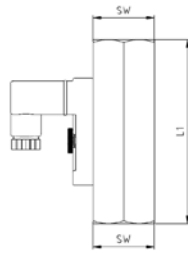

mit Kabelkontakt

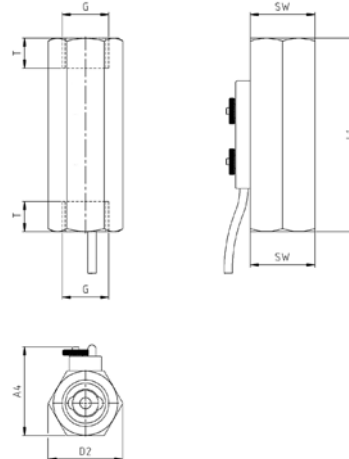

Summary of types RVP/U

Type	Switch range ⁽¹⁾ l/min H ₂ O	Overall dimensions mm											Weight approx. [g]	
		G	DN	D1	D1	SW	L1	L2	T	A1	A2	A3		A4
RVP/U-2/02	0,02 - 0,21	1/2"	15	-	34,6	30	90	-	14	-	-	-	70	150
RVP/U-2/06	0,2 - 0,6													
RVP/U-2/1	0,4 - 1,8													
RVP/U-2/3	0,8 - 3,2													
RVP/U-2/7	2 - 7													
RVP/U-2/13	3 - 13													
RVP/U-2/20	4 - 20													
RVP/U-2/30	8 - 30													

⁽¹⁾ Other switch ranges on request

Connection diagram

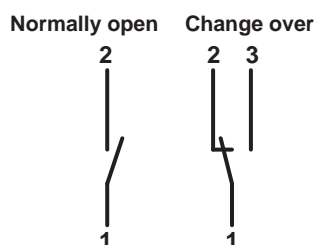

Operating data		RVP/U-2
Operating pressure:		PN 10 bar
Pressure drop:		0,02 - 0,3 bar
Maximum temperature:		50 °C
Accuracy:		10% of full scale
Electrical data:		
Normally open:		max. 230V • 3A • 60VA
Change over: ⁽³⁾		max. 250V • 1,5A • 50VA ⁽²⁾
Protection type: ⁽⁴⁾		IP65 (plug connection DIN 43650 Form C) IP67 (1m sealed in cable)
Output signal:		The contact opens / changes, when the flow falls below the set point.
Power supply:		Not required (potentialfree reed contact)
Other plug types or cable lengths on request		
Material:		
Housing:	(wetted part)	PVC-U (Hard-PVC)
Floater:	(wetted part)	1.4571
Magnets:	(wetted part)	Hardferrit
Spring:	(wetted part)	1.4571
Stop rings:	(wetted part)	1.4571

⁽²⁾ Minimum load 3VA

⁽³⁾ Only with plug connection

⁽⁴⁾ Cable connection (IP67) only with normally open

RVP/U 2 0007 07-15 E M